

DSP168

20W Coaxial In-Wall / Ceiling Speaker 70V / 100V



Description

The DSP168 20W Coaxial In-Wall / Ceiling Speaker is designed for 70V/100V constant voltage background music and public address systems, delivering clear and balanced audio for distributed sound applications.

Constructed with durable engineering-grade materials, it combines stable acoustic performance with a clean and discreet design for seamless ceiling or wall integration. Its optimized driver configuration improves mid and high frequency separation, reducing distortion and ensuring consistent sound reproduction across various installation environments.

Features

- 20W ceiling speaker designed for 70V/100V constant voltage audio systems.
- 1-inch Mylar dome tweeter with ferrofluid cooling for enhanced high-frequency performance and reliability.
- 6.5-inch paper cone woofer with rubber surround for stable mid-low frequency response.
- Bass-reflex design with dual ports for improved low-frequency extension.
- Wide dispersion coverage for uniform sound distribution in multi-zone environments.
- High-efficiency magnetic structure for consistent and stable audio output.
- Suitable for commercial spaces such as offices, retail stores, restaurants, and public areas.

Model	DSP168
Rated Power	20W
Constant Voltage	70V/100V
Frequency Response	60Hz-20,000Hz
Sensitivity	89±2dB
MAX. SPL.	102±2dB
Dimensions	Φ233×97mm
Weight	2.1kg

Installation

Step 1. Press to ascend the method of the diagram trumpet net the crest outs.

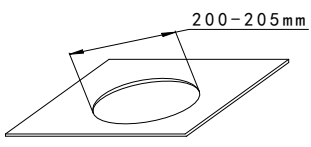

Step 2. Cut a Ø 200mm - Ø 205mm installation hole on ceiling as shown above.

Step 3. Connect public address wire to the terminals.

Step 4. Push the loudspeaker into your ceiling, beat with screw tight and install the net.

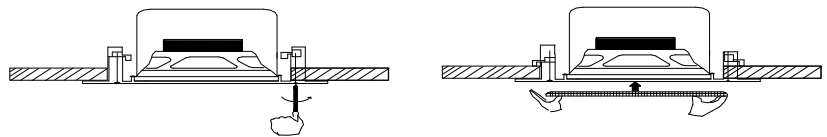

Step 5. Adjust the direction of the set and examine whether it is steady.

Frequency Response & Distortion

